

102	SLEEVE	1	----
101	BREATHER	1	----
100	O-RING	1	(Ø71 X 3.53)
99	OIL LEVEL GAUGE	3	----
98	SHIM1 TØ1.5	1	----
97	FUSIBLE PLUG	1	----
95	ROLLER CHAIN	1	ISO 108
86	SPRING WASHER	1	IS 1367 Gr. 8.8
85	HEX HEAD BOLT	1	IS 1367 Gr. 8.8
84	LOCK PLATE	1	----
83	SPRING WASHER	8	IS 1367 Gr. 8.8
82	HEX HEAD BOLT	8	IS 1367 Gr. 8.8
81	SPROCKET	1	----
80	KEY	1	----
79	PUMP ADAPTOR	1	----
78	GEAR PUMP	1	----
77	SPRING WASHER	18	IS 1367 Gr. 8.8
76	HEX HEAD BOLT	18	IS 1367 Gr. 8.8
65	SPRING WASHER	8	IS 1367 Gr. 8.8
64	HEX HEAD BOLT	8	IS 1367 Gr. 8.8
63	SPROCKET COVER	1	----
62	SPRING WASHER	4	IS 1367 Gr. 8.8
61	HEX HEAD BOLT	4	IS 1367 Gr. 8.8
60	BAFFLE	1	----
59	BOX-HOUSING	1	IS9975
57	COPPER WASHER	4	----
56	HEX HEAD BOLT	12	IS 1367 Gr. 8.8
55	FLEX. COUPLING	1	IS 1367 Gr. 8.8
54	FAST-RING	1	----
53	HEX HEAD BOLT	8	----

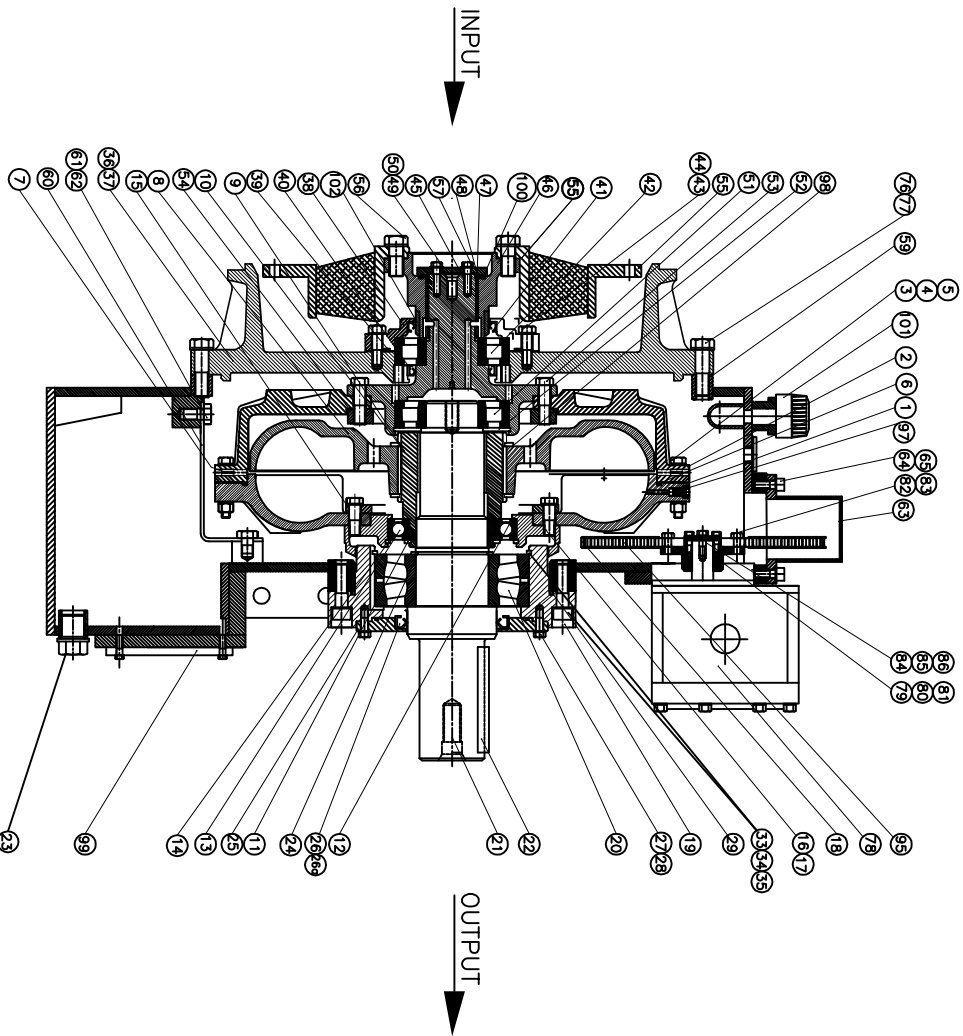

52	INT CIRCLIP	1	----
51	CYL ROLLER BRG.	1	----
50	BONDED WASHER	4	----
49	HEX HEAD BOLT	4	----
48	RET. WASHER	1	----
47	O RING	1	Ø57x4
46	I/P SPLINE HUB	1	----
45	I/P SPLINE SHAFT	1	----
44	SPRING WASHER	8	----
43	HEX HEAD BOLT	8	----
42	CYL. ROLLER BRG	1	----
41	OIL SEAL	1	----
40	OIL SEAL	1	----
39	O RING	1	----
38	INPUT SEAL HSG	1	----
37	GRUB SCREW	2	----
36	SAE FLANGE	1	----
35	INT CIRCLIP	1	----
34	GRUB SCREW	2	----
33	HEX SOCKET HD.BOLT	12	----
29	O RING	1	----
28	HEX HEAD BOLT	6	----
27	SPRING WASHER	6	----
26	OIL SEAL O/P	1	----
25	O/P SEAL HSG	1	----
24	EXT.CIRCLIP	1	----
23	DRAIN PLUG	2	----
22	SHAFT KEY	1	----
21	MAIN SHAFT	1	----
20	SPL ROLLER BRG	1	----
19	CASING BRG LINER	1	----
18	SPROCKET	1	----
17	SPRING WASHER	8	----
16	HEX HEAD BOLT	8	----
15	FAST. RING	1	----
14	INT. CIRCLIP	1	----
13	BALL BEARING	1	----
12	IMP. BRG. LINER	1	----
11	EXT.CIRCLIP	1	----
10	EXT. CIRCLIP	2	----
9	RUNNER HUB	1	----
8	RUNNER	1	AL ALLOY
7	LEAK OFF NOZZLE	4	----
6	O-RING	1	IS9975
5	PLAIN WASHER	36	IS 1367 Gr. 8.8
4	NYLOCK NUT	36	IS 1367 Gr. 8.8
3	HEX HEAD BOLT	36	IS 1367 Gr. 8.8
2	CASING	1	----
1	IMPELLER	1	----

NOTE: THIS DRAWING SHOWS GENERAL CROSS SECTIONAL ARRANGEMENT OF A PSM MODEL. FOR EXACT SIZES, ACTUAL DIMENSIONS AND OTHER DETAILS, REFER DRAWING.

The Manufacturer undertakes to take Government & the proprietary and industrial rights of design & patent which are covered from the date of issue.