

COMBI MOUNTS TYPE PC



POLYBOND COMBIMOUNTS PC are suitable for a wide variety of equipment. The COMBIMOUNT PC, is low in profile, compact in size and Ideal for mobile application due to added "Fail safe" feature. These mounts can be supplied with a height adjustment feature if required.

PART NO		LOAD (kg)	DEFLECTION (mm)
PC100	A	50	4
	B	70	
	C	100	
PC140	A	135	5
	B	200	
	C	300	
PC182	A	355	5
	B	530	
	C	800	
	D	1000	

ALL DIMENSIONS IN mm.

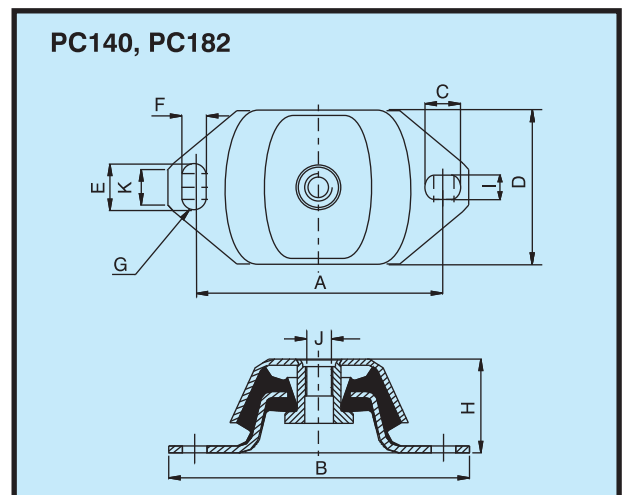
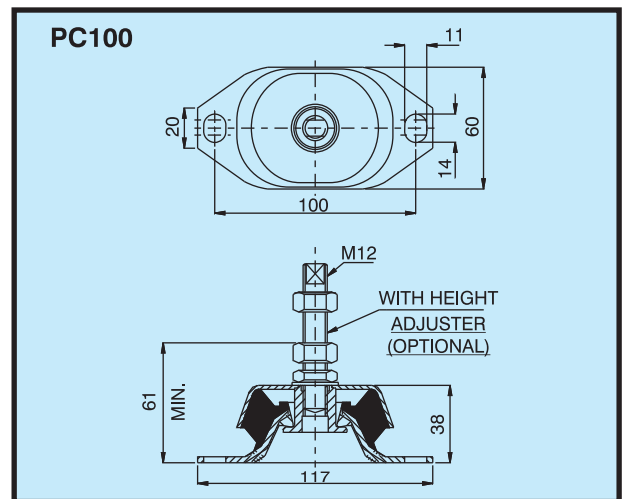

PART NO.	DIMENSIONS (mm)										
	A	B	C	D	E	F	G	H	I	J	K
PC140	140	178	20	76	30	13	6.5	49	13	M16	25
PC182	182	220	26	112	34	18	9.0	70	18	M20	28

When placing orders please specify "Type I" (Without height adjustment feature) or "Type II" (With height adjustment feature)